

# ENCLOSURE

## DIN RAIL / SERIES : ED.7500

ISSUE - PIS/ED.7522/45  
DATE : 01.07.2015

Order Code : ED.7522

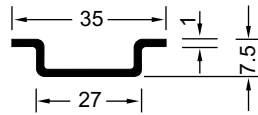
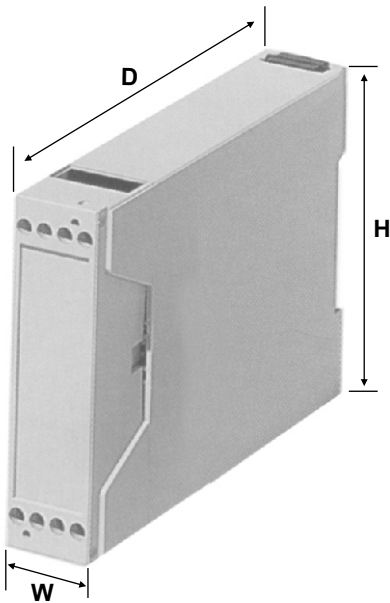

DIN RAIL-DIN en.50022

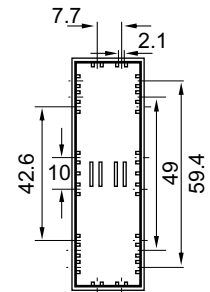
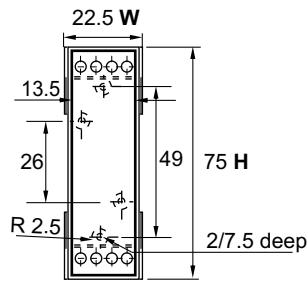

PCB Dimension	
W	D
18.5 ± 0.1	74.0 ± 0.1

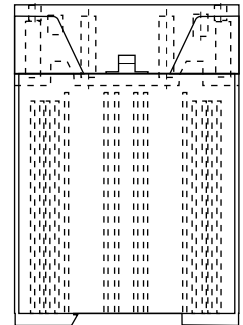
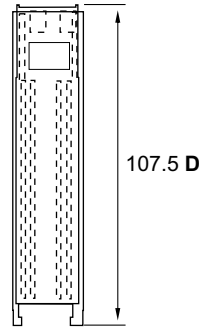

### ENCLOSURE ED.7522 (TERMINALS 4+4)

Compact Enclosure For Electronic, Electrical Sub-systems, Like Timers, Counters, Level Switches, Etc, Moulded In ABS Light Grey Colour With Provision For 4+4 PCB Type Mountable Terminal Blocks With 5.08 mm Pitch, (available On Request) These Enclosures Can Be Latched Onto 35 mm Din-Rail en.50022.

Size: W-22.5, D-107.5, H-75 mm

Order Code : ED.7545

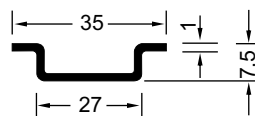

DIN RAIL-DIN en.50022

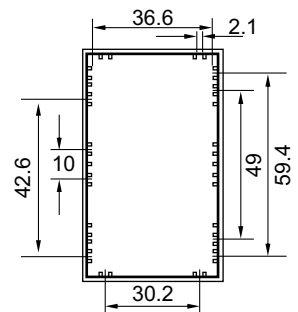
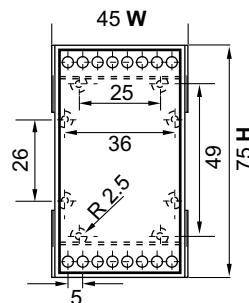

PCB Dimension	
W	D
41.0 ± 0.1	74.0 ± 0.1
71.0 ± 0.1	74.0 ± 0.1

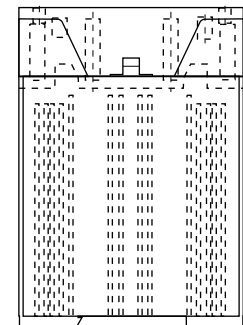
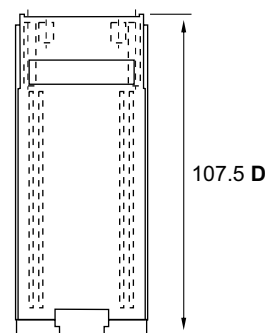

### ENCLOSURE ED.7545 (TERMINALS 8+8)

Compact Enclosure For Electronic, Electrical Sub-systems, Like Timers, Counters, Level Switches, Etc, Moulded In ABS Light Grey Colour With Provision For 8+8 PCB Type Mountable Terminal Blocks With 5.08 mm Pitch, (available On Request) These Enclosures Can Be Latched Onto 35mm Din-Rail en.50022.

Size: W-45, D-107.5, H-75mm

Manufactured by:

**piri electrols pvt. ltd.**

A-28, Royal Industrial Estate, Naigaum Cross Road, Wadala, Mumbai 400031. INDIA.

☎ (022) 2412 8342/43 • Fax: (022) 2414 9077 • E-Mail : [pirielectrols@gmail.com](mailto:pirielectrols@gmail.com) • Website : [www.pirielectrols.com](http://www.pirielectrols.com)

